

NOTE RE. SERVICES
 APPROXIMATE LOCATIONS OF EXISTING SERVICES SHOWN ON LONGITUDINAL SECTION. EXACT LOCATIONS & DEPTHS TO BE ACCURATELY LOCATED BY THE BUILDING CONTRACTOR BY CONTACTING THE RELEVANT AUTHORITIES BEFORE COMMENCEMENT OF ANY WORKS



SYMBOLS

- F. F. L. FINISHED FLOOR LEVEL
- T. K. TOP OF KERB
- RL PIT SURFACE LEVEL
- IL INVERT LEVEL
- STORMWATER DRAINAGE PIPE
- - - DOWNPIPE TO RAINWATER TANK
- DP 100 DOWN PIPE (U. N. O.)
- SP SPREADER
- IE INSPECTION EYE
- RWH RAINWATER HEAD
- ▨ MASONRY RETAINING WALL
- ⊗ FW FLOOR WASTE 150
- ▣ GRATED INLET PIT
- ▨ GRATED DRAIN
- ← OVERLAND FLOW PATH
- ES EMERGENCY SPILLTER
- VD VERTICAL DROP
- EDP EXISTING 100 DOWN PIPE (U. N. O.)
- EXISTING STORMWATER DRAINAGE PIPE

NOTES

1. ALL LINES ARE TO BE MIN. 100ϕ UPVC @ MIN 1.0% GRADE UNLESS NOTED OTHERWISE.
2. IT IS THE CONTRACTORS RESPONSIBILITY TO LOCATE & LEVEL ALL EXISTING SERVICES PRIOR TO THE COMMENCEMENT OF ANY EARTHWORKS. ALL DESIGN LEVELS SHOWN ON PLAN SHALL BE VERIFIED ON SITE PRIOR TO THE COMMENCEMENT OF ANY WORK.
3. ALL PIPES TO HAVE MIN 200mm COVER IF LOCATED WITHIN PROPERTY.
4. ALL PITS IN DRIVEWAYS BE HEAVY DUTY GRATES. DIRECT SURFACE FLOW TO ALL GRATED SURFACE INLET PITS.
5. ALL WORK DO BE DONE IN ACCORDANCE WITH AS/NZ 3500.3.2:2003 AND COUNCIL SPECIFICATIONS.
6. LOCATION OF DOWNPIPES & FLOOR WASTES ARE INDICATIVE ONLY. DOWNPIPE & FLOOR WASTE SIZE, LOCATION & QUANTITY TO BE DETERMINED BY BUILDER & IN ACCORDANCE WITH RELEVANT AUSTRALIAN STANDARDS.
7. THIS PLAN IS TO BE READ IN CONJUNCTION WITH THE ARCHITECTURAL, LANDSCAPE AND STRUCTURAL PLANS.
8. ANY DISCREPANCIES OR OMISSIONS SHALL BE REFERRED TO THE DESIGN ENGINEER FOR RESOLUTION.
9. ALL PITS OR GRATES IN TRAFFICABLE AREAS TO BE HEAVY DUTY.
10. ALL GUTTERS WILL BE FITTED WITH LEAF GUARDS AND SHOULD BE INSPECTED AND CLEANED TO ENSURE LEAF LITTER CANNOT ENTER THE DOWNPIPES

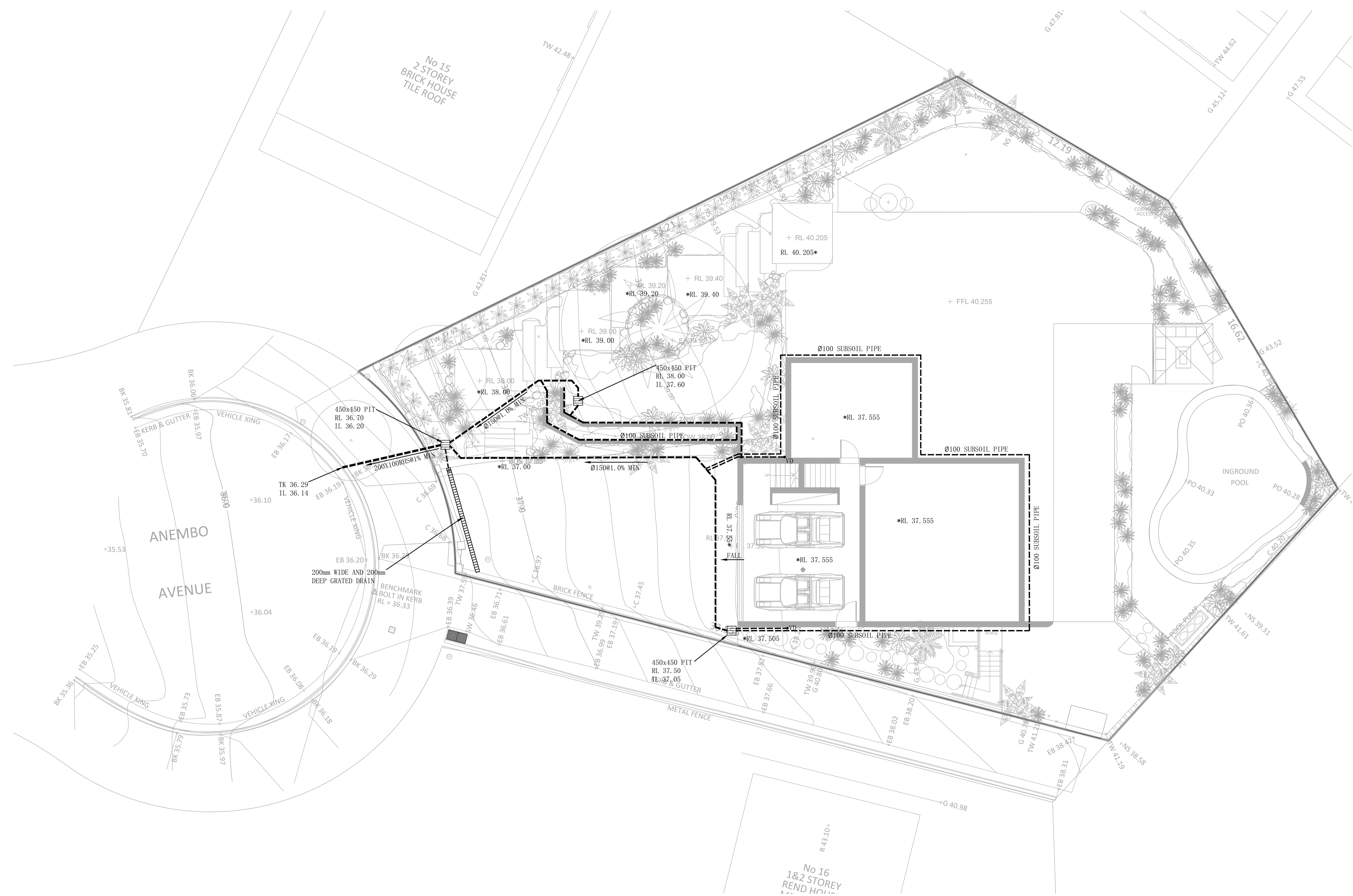

GARAGE FLOOR STORMWATER DRAINAGE PLAN
 SCALE 1:100

Rev	Description	By	App	Date
C	FOR DA APPROVAL	SH	IN	11/07/22
B	FOR DA APPROVAL	SH	IN	06/07/22
A	FOR DA APPROVAL	SH	IN	29/04/22

Engineering Consultant
STRONGHOLD ENGINEERS
 Email: admin@shens.com.au
 Ph: 02 6100 1148
 Suite 65 89-97 JONES STREET
 ULTIMO NSW 2007

Client
Cheryl Nguyen

Project
**17 ANEMBO AVE,
 GEORGES HALLS
 NSW 2198**

Drawing Title
**GARAGE FLOOR STORMWATER
 DRAINAGE PLAN**

THESE DRAWINGS AND THE DESIGNS WITHIN ARE COPYRIGHT. THEY ARE NOT TO BE USED FOR ANY PURPOSE OTHER THAN THE NOMINATED PROJECT. THE DRAWINGS REMAIN THE PROPERTY OF SHENS AND ARE NOT TO BE REPRODUCED OR ALTERED WITHOUT WRITTEN PERMISSION.

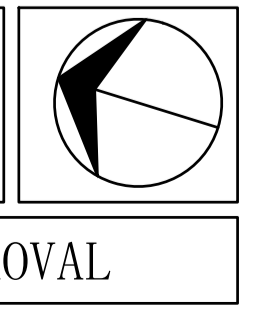

Project Number SH22154	Drawing Number ST01	Revision C
Engineer SH	Drawn IN	
Date APR 2022	Scale 1:100 A1	

FOR DA APPROVAL

NOTE RE. SERVICES
 APPROXIMATE LOCATIONS OF EXISTING SERVICES SHOWN ON LONGITUDINAL SECTION. EXACT LOCATIONS & DEPTHS TO BE ACCURATELY LOCATED BY THE BUILDING CONTRACTOR BY CONTACTING THE RELEVANT AUTHORITIES BEFORE COMMENCEMENT OF ANY WORKS



SYMBOLS

- F.F.L. FINISHED FLOOR LEVEL
- T.K. TOP OF KERB
- RL PIT SURFACE LEVEL
- IL INVERT LEVEL
- STORMWATER DRAINAGE PIPE
- - - DOWNPIPE TO RAINWATER TANK
- DP 100 DOWN PIPE (U.N.O.)
- SP SPREADER
- IE INSPECTION EYE
- RWH RAINWATER HEAD
- /// MASONRY RETAINING WALL
- ⊗ FW FLOOR WASTE 150
- ▣ GRATED INLET PIT
- ▨ GRATED DRAIN
- ← OVERLAND FLOW PATH
- ES EMERGENCY SPILLITER
- VD VERTICAL DROP
- EDP EXISTING 100 DOWN PIPE (U.N.O.)
- EXISTING STORMWATER DRAINAGE PIPE

NOTES

1. ALL LINES ARE TO BE MIN. 100 Ø PVC @ MIN 1.0% GRADE UNLESS NOTED OTHERWISE.
2. IT IS THE CONTRACTORS RESPONSIBILITY TO LOCATE & LEVEL ALL EXISTING SERVICES PRIOR TO THE COMMENCEMENT OF ANY EARTHWORKS. ALL DESIGN LEVELS SHOWN ON PLAN SHALL BE VERIFIED ON SITE PRIOR TO THE COMMENCEMENT OF ANY WORK.
3. ALL PIPES TO HAVE MIN 200mm COVER IF LOCATED WITHIN PROPERTY.
4. ALL PITS IN DRIVEWAYS BE HEAVY DUTY GRATES. DIRECT SURFACE FLOW TO ALL GRATED SURFACE INLET PITS.
5. ALL WORK DO BE DONE IN ACCORDANCE WITH AS/NZ 3500.3.2:2003 AND COUNCIL SPECIFICATIONS.
6. LOCATION OF DOWNPIPES & FLOOR WASTES ARE INDICATIVE ONLY. DOWNPIPE & FLOOR WASTE SIZE, LOCATION & QUANTITY TO BE DETERMINED BY BUILDER & IN ACCORDANCE WITH RELEVANT AUSTRALIAN STANDARDS.
7. THIS PLAN IS TO BE READ IN CONJUNCTION WITH THE ARCHITECTURAL, LANDSCAPE AND STRUCTURAL PLANS.
8. ANY DISCREPANCIES OR OMISSIONS SHALL BE REFERRED TO THE DESIGN ENGINEER FOR RESOLUTION.
9. ALL PITS OR GRATES IN TRAFFICABLE AREAS TO BE HEAVY DUTY.
10. ALL GUTTERS WILL BE FITTED WITH LEAF GUARDS AND SHOULD BE INSPECTED AND CLEANED TO ENSURE LEAF LITTER CANNOT ENTER THE DOWNPIPES

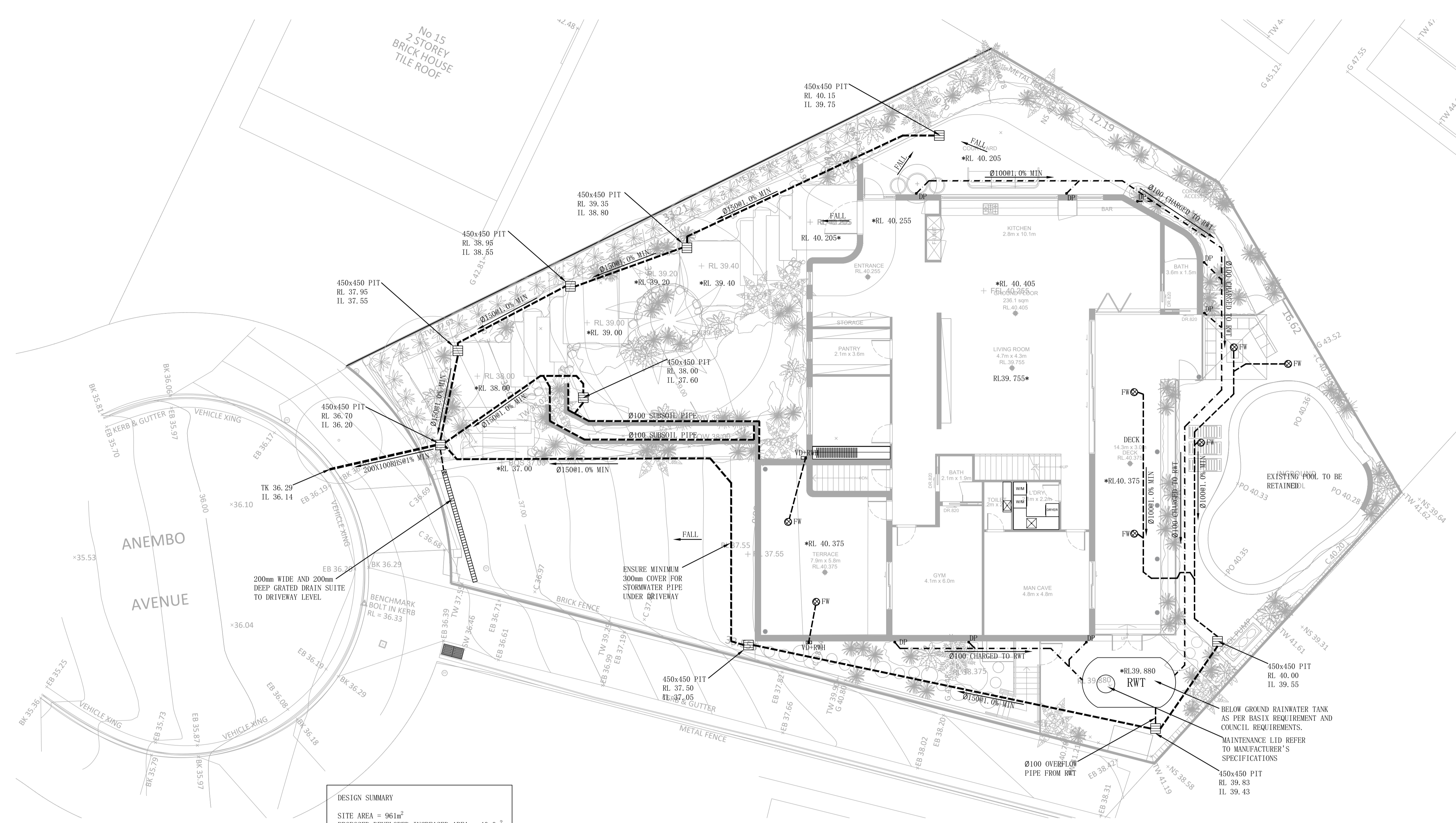

DESIGN SUMMARY
 SITE AREA = 961m²
 PROPOSED DEVELOPED INCREASED AREA = 40.0m²
 ACCORDING TO COUNCIL'S DCP, FOR PROPOSED DEVELOPMENT WHICH DOES NOT SIGNIFICANTLY INCREASE THE POST DEVELOPMENT STORMWATER RUNOFF FROM THE SITE, OSD IS NOT REQUIRED

GROUND FLOOR STORMWATER DRAINAGE PLAN
 SCALE 1:100

NOTES: RAINWATER TANKS

1. RAINWATER TANK CAPACITY AS PER BASIX CERTIFICATE.
2. THE SYSTEM TO BE DESIGNED WITH THE FOLLOWING GUIDELINES
 - A 'FIRST FLUSH' DIVERSION TO REMOVE ROOF CONTAMINANTS
 - ADEQUATE SCREENING TO PREVENT MOSQUITO BREEDING AND ENTRY OF ANIMALS OR FOREIGN MATTER
3. TANKS TO BE PLUMBED TO TOP-UP FROM THE POTABLE WATER SUPPLY DURING DRY PERIODS WHEN THE TANKS ARE 80% EMPTY.
4. NO DIRECT CROSS-CONNECTION WITH THE SYDNEY WATER POTABLE SUPPLY AND AN AIR GAP MAINTAINED ABOVE THE OVERFLOW IN THE TANK.
5. A BACK FLOW PREVENTION DEVICE SHALL BE PROVIDED AT THE WATER METER IN ACCORDANCE WITH SYDNEY WATER REQUIREMENT.
6. A SIGN TO BE INSTALLED STATING *NOT FOR HUMAN CONSUMPTION.
7. RAINWATER TANK TO BE CONNECTED AS PER BASIX REQUIREMENTS
8. OVERFLOW FROM THE TANK SHALL BE PIPED TO THE DRAINAGE SYSTEM.

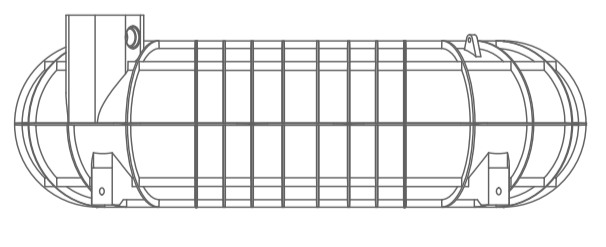
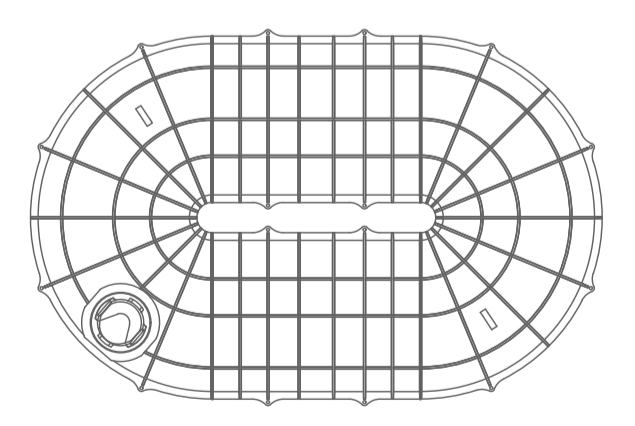
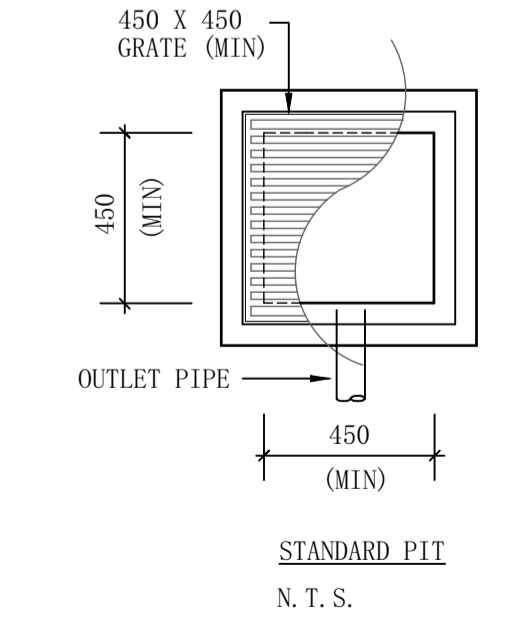
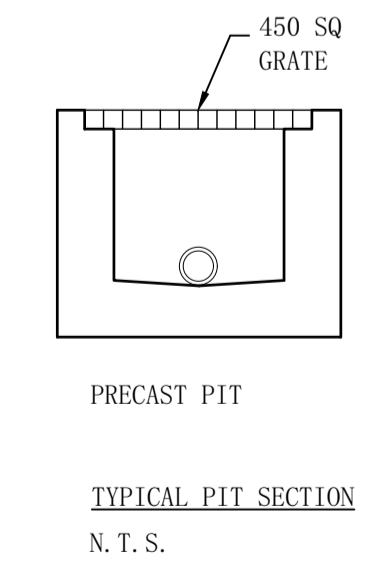
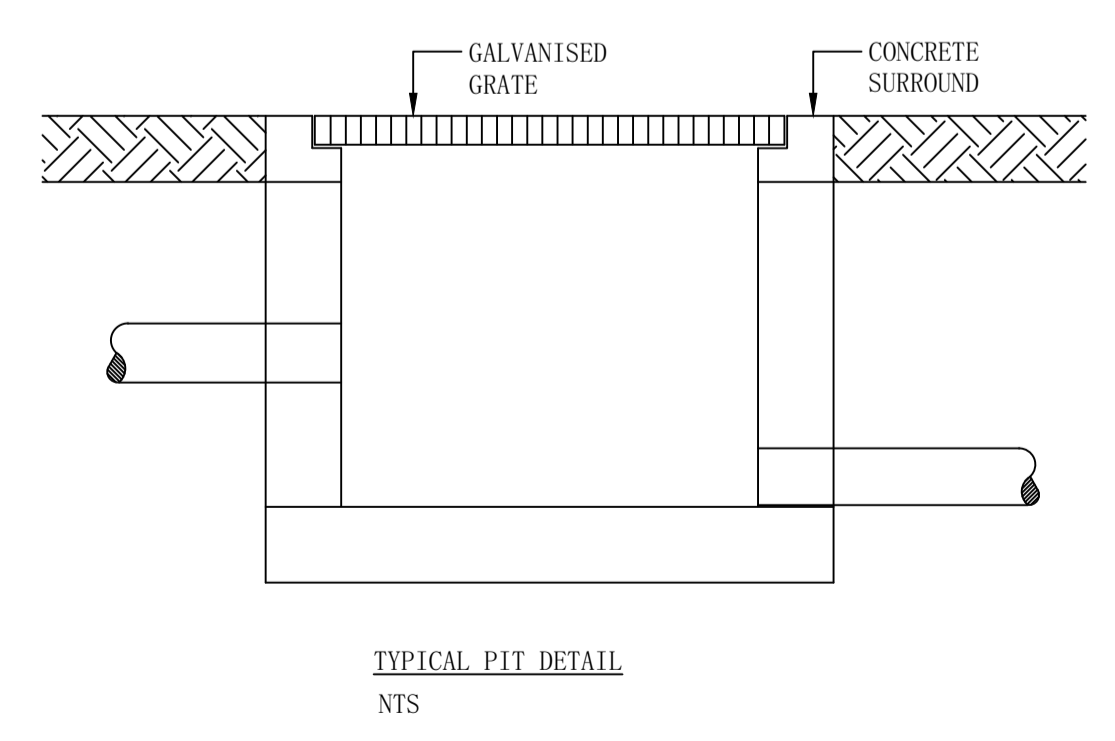

PLAN OF RAINWATER TANK
 N.T.S.
 DENOTES RAINWATER TANK
 MANUFACTURER- TANKMSTA TOROID UNDERGROUND TANK
 TANK SHALL BE INSTALLED TO MANUFACTURERS SPECIFICATIONS

SIDE VIEW OF RAINWATER TANK
 N.T.S.

C	FOR DA APPROVAL	SH	IN	11/07/23	
B	FOR DA APPROVAL	SH	IN	06/07/23	
A	FOR DA APPROVAL	SH	IN	29/04/23	
Rev	Description	By	App	Date	

Engineering Consultant
STRONGHOLD ENGINEERS
 Email: admin@shens.com.au
 Ph: 02 6100 1148
 Suite 65 89-97 JONES STREET
 ULTIMO NSW 2007

Client
Cheryl Nguyen

Project
**17 ANEMBO AVE,
 GEORGES HALLS
 NSW 2198**

Drawing Title
**SITE STORMWATER DRAINAGE
 PLAN**

THESE DRAWINGS AND THE DESIGNS WITHIN ARE COPYRIGHT. THEY ARE NOT TO BE USED FOR ANY PURPOSE OTHER THAN THE NOMINATED PROJECT. THE DRAWINGS REMAIN THE PROPERTY OF SHENS AND ARE NOT TO BE REPRODUCED OR ALTERED WITHOUT WRITTEN PERMISSION.

FOR DA APPROVAL

Project Number	Drawing Number	Revision
SH22154	ST02	C
Engineer	Drawn	
SH	IN	
Date	Scale	
APR 2022	1:100 A1	

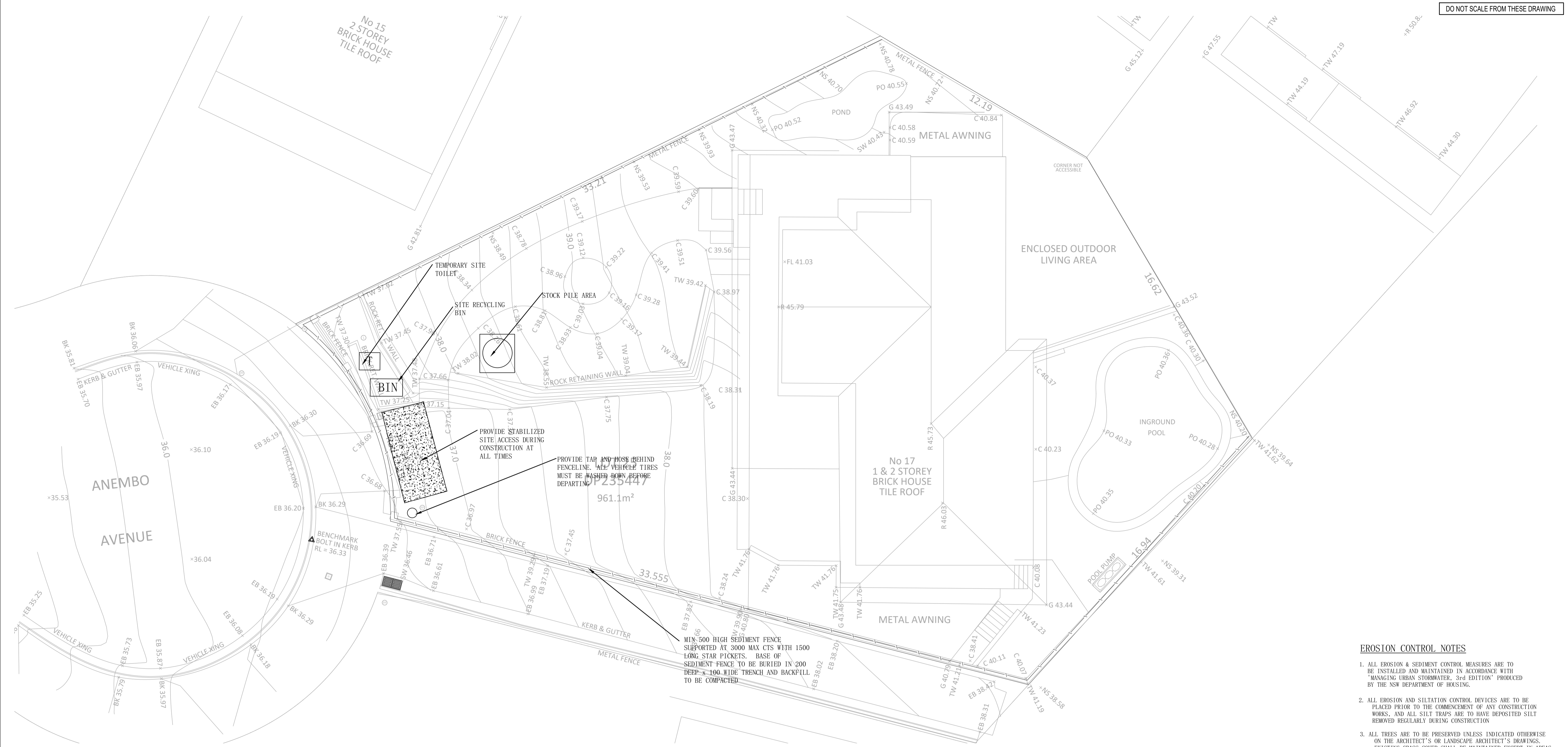

EROSION AND SEDIMENT CONTROL PLAN
SCALE 1:100

- EROSION CONTROL NOTES**
1. ALL EROSION & SEDIMENT CONTROL MEASURES ARE TO BE INSTALLED AND MAINTAINED IN ACCORDANCE WITH "MANAGING URBAN STORMWATER, 3rd EDITION" PRODUCED BY THE NSW DEPARTMENT OF HOUSING.
 2. ALL EROSION AND SILTATION CONTROL DEVICES ARE TO BE PLACED PRIOR TO THE COMMENCEMENT OF ANY CONSTRUCTION WORKS, AND ALL SILT TRAPS ARE TO HAVE DEPOSITED SILT REMOVED REGULARLY DURING CONSTRUCTION.
 3. ALL TREES ARE TO BE PRESERVED UNLESS INDICATED OTHERWISE ON THE ARCHITECT'S OR LANDSCAPE ARCHITECT'S DRAWINGS. EXISTING GRASS COVER SHALL BE MAINTAINED EXCEPT IN AREAS CLEARED FOR BUILDINGS, PAVEMENTS ETC.
 4. INSTALL TEMPORARY SEDIMENT BARRIERS TO ALL INLET PITS LIKELY TO COLLECT SILT LADEN WATER.
 5. NOT WITHSTANDING DETAILS SHOWN IT IS THE CONTRACTORS SOLE RESPONSIBILITY TO ENSURE THAT ALL SITE ACTIVITIES COMPLY WITH THE REQUIREMENTS OF THE CLEAN WATERS ACT.

- SYMBOLS**
- EXISTING CONTOURS
 - - - SILT FENCE
 - - - WIRE MESH FENCE
 - Ø50 PUMP LINE

- NOTES: SOIL & WATER MANAGEMENT**
1. ALL EROSION AND SEDIMENT CONTROL MEASURES TO BE INSPECTED AND MAINTAINED DAILY BY SITE MANAGER.
 2. MINIMISE DISTURBED AREAS.
 3. ALL STOCKPILES TO BE CLEAR FROM DRAINS, GUTTERS AND FOOTPATHS.
 4. DRAINAGE IS TO BE CONNECTED TO STORMWATER SYSTEM AS SOON AS POSSIBLE.
 5. ROADS AND FOOTPATH TO BE SWEEP DAILY.
 6. NO MATERIAL TO BE STORED ON FOOTPATH.
 7. IF YOU DO NOT COMPLY YOU MAY BE LIABLE TO A \$1500 FINE.

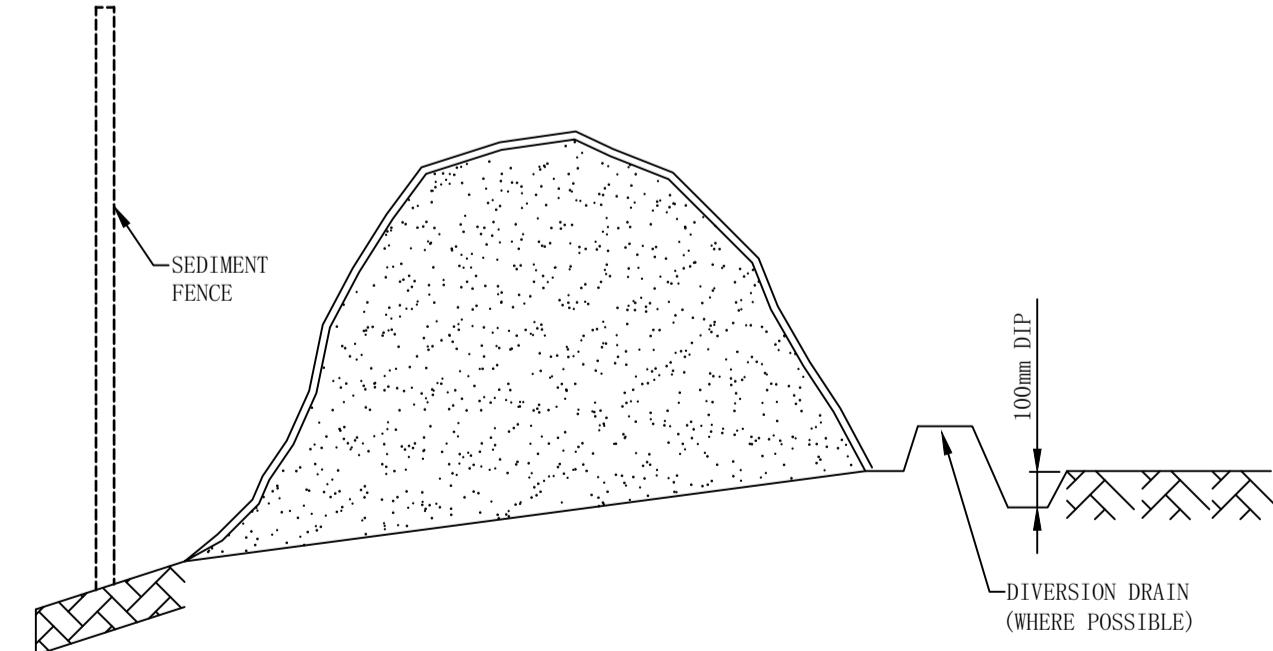
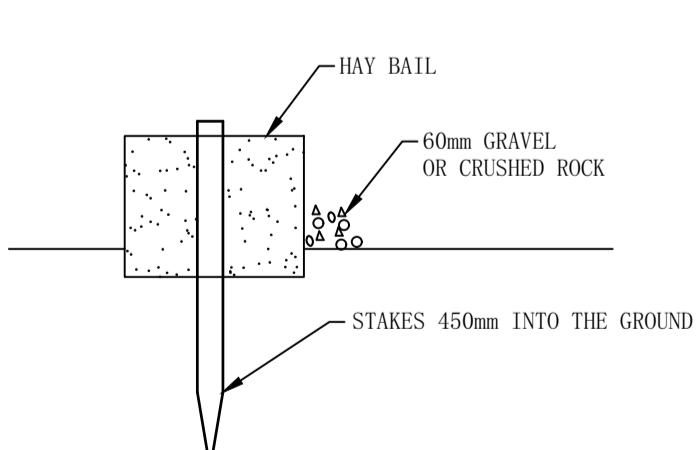
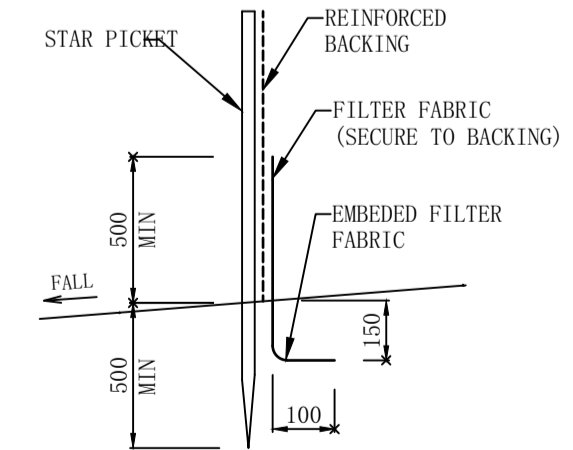
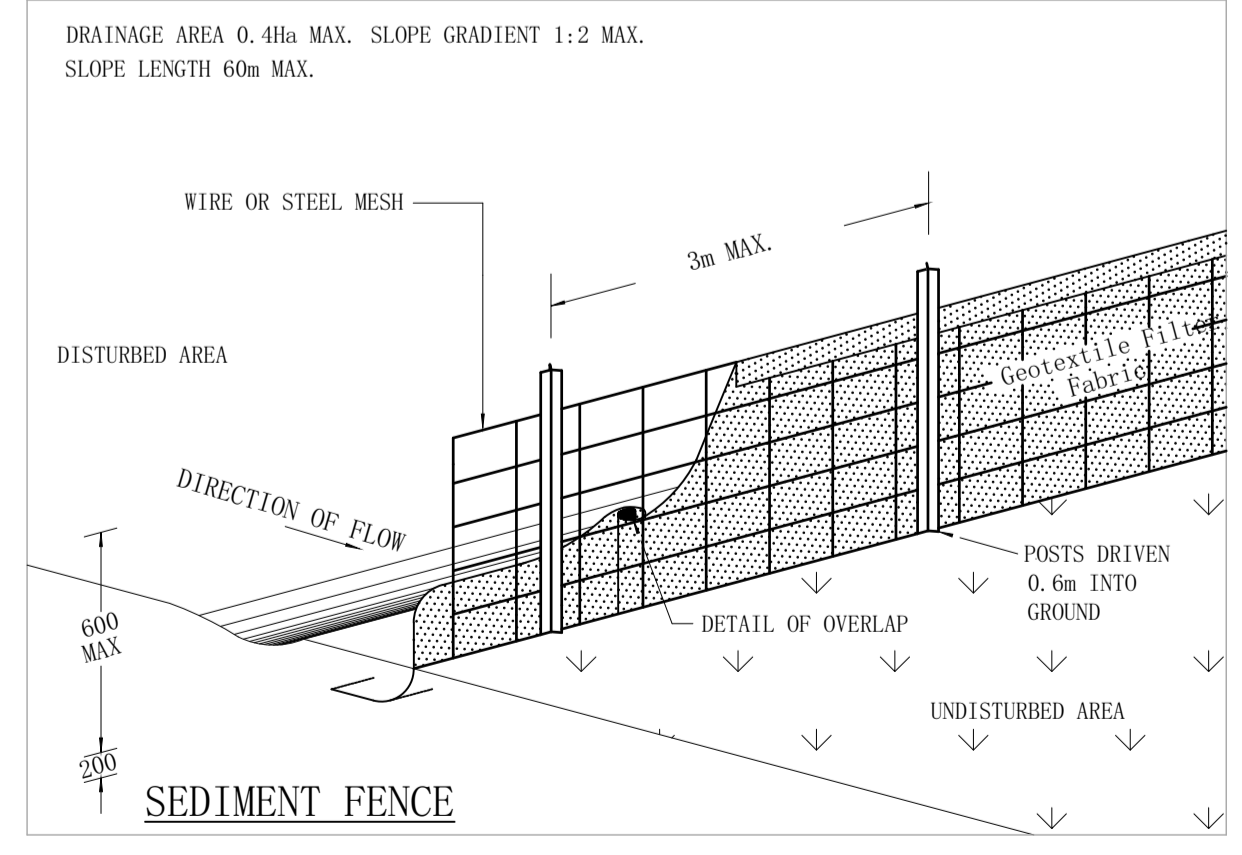
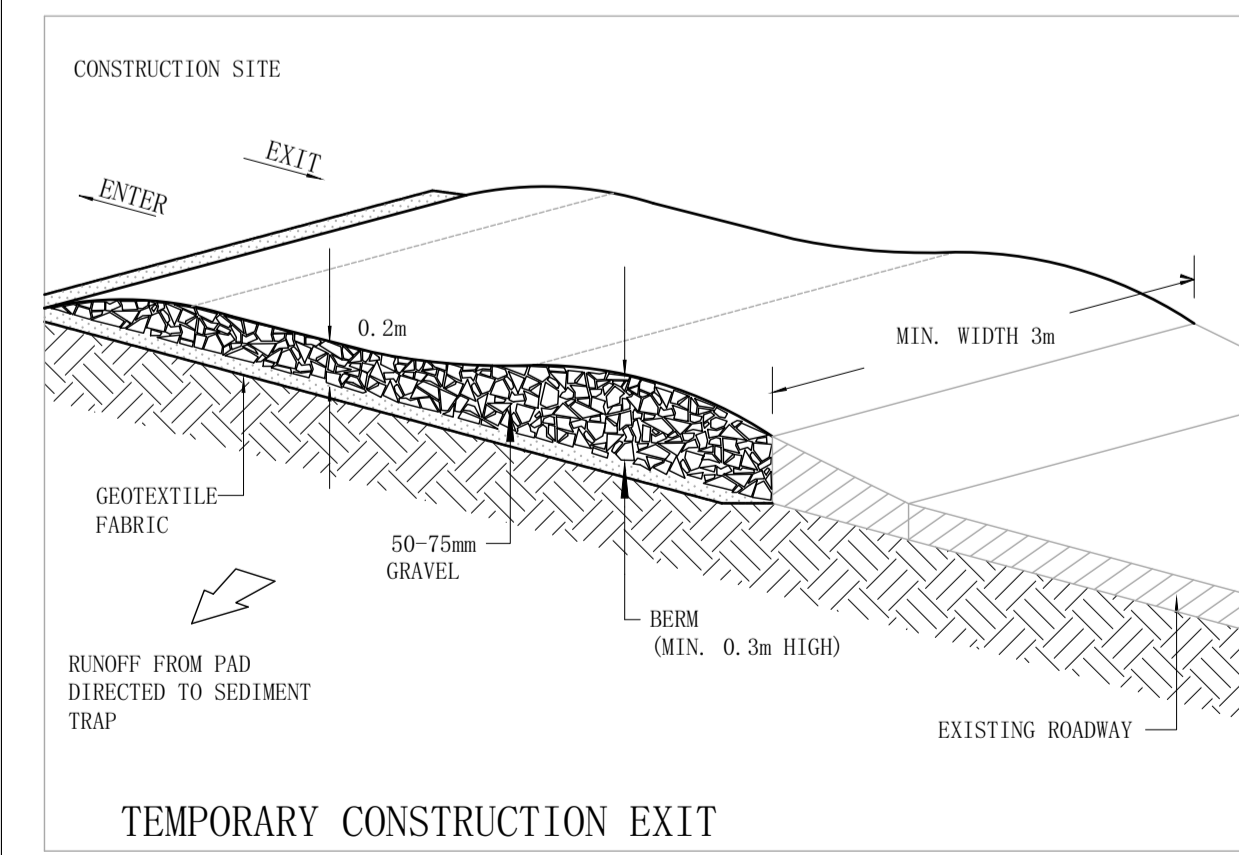

SILT FENCE DETAIL
HAY BAIL DETAIL
TO BE USED AS REQUIRED

Rev	Description	By	App	Date
C	FOR DA APPROVAL	SH	IN	11/07/22
B	FOR DA APPROVAL	SH	IN	06/07/22
A	FOR DA APPROVAL	SH	IN	29/04/22

Engineering Consultant
STRONGHOLD ENGINEERS
Email: admin@shens.com.au
Ph: 02 6100 1148
Suite 65 89-97 JONES STREET
ULTIMO NSW 2007

Client
Cheryl Nguyen

Project
**17 ANEMBO AVE,
GEORGES HALLS
NSW 2198**

Drawing Title
**EROSION AND SEDIMENT CONTROL
PLAN AND DETAILS**

THESE DRAWINGS AND THE DESIGNS WITHIN ARE COPYRIGHT. THEY ARE NOT TO BE USED FOR ANY PURPOSE OTHER THAN THE NOMINATED PROJECT. THE DRAWINGS REMAIN THE PROPERTY OF SHENS AND ARE NOT TO BE REPRODUCED OR ALTERED WITHOUT WRITTEN PERMISSION.

FOR DA APPROVAL

Project Number	Drawing Number	Revision
SH22154	ST03	C
Engineer	Drawn	
SH	IN	
Date	Scale	
APR 2022	1:100 A1	